

FRONT ELEVATION

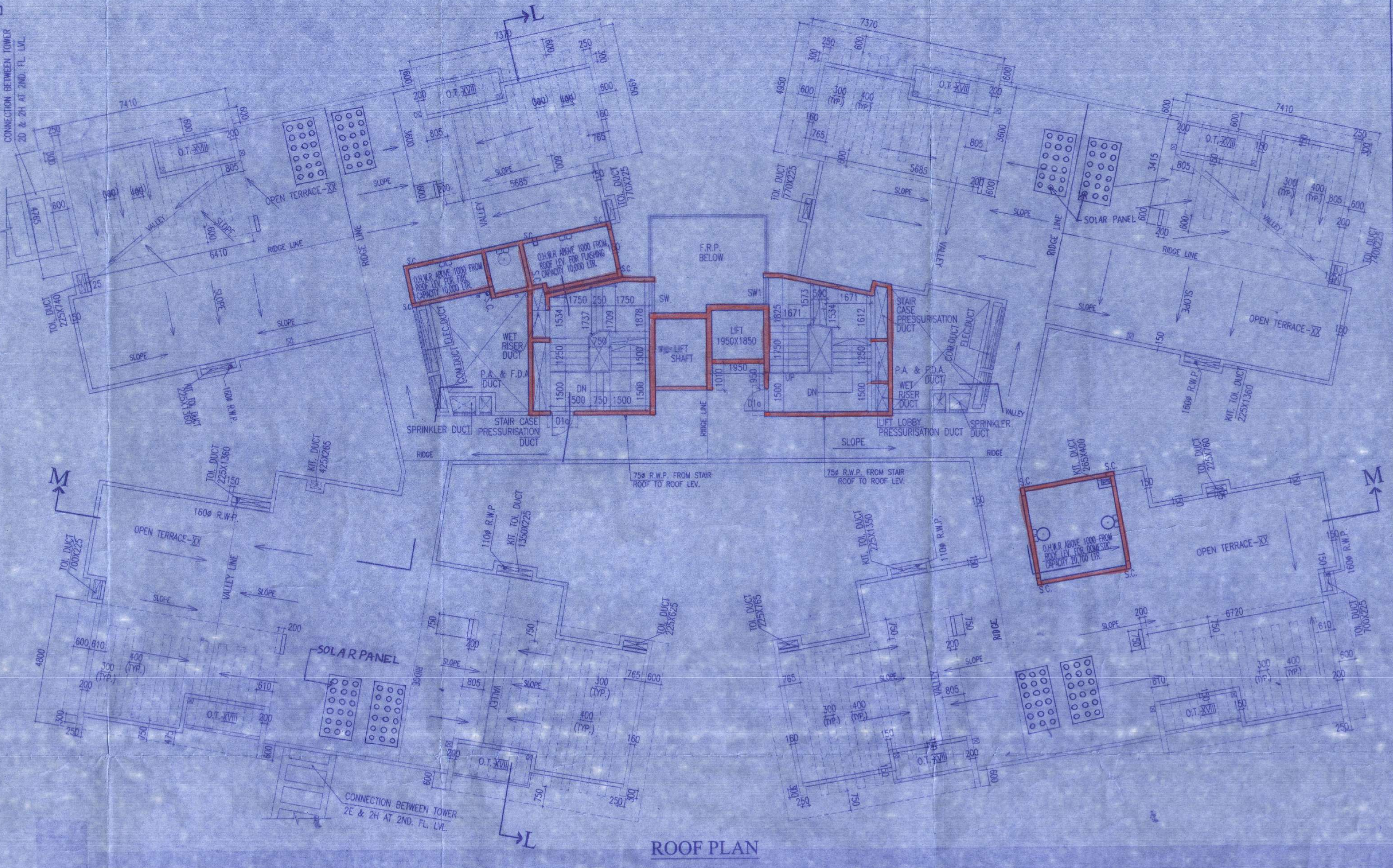

ROOF PLAN

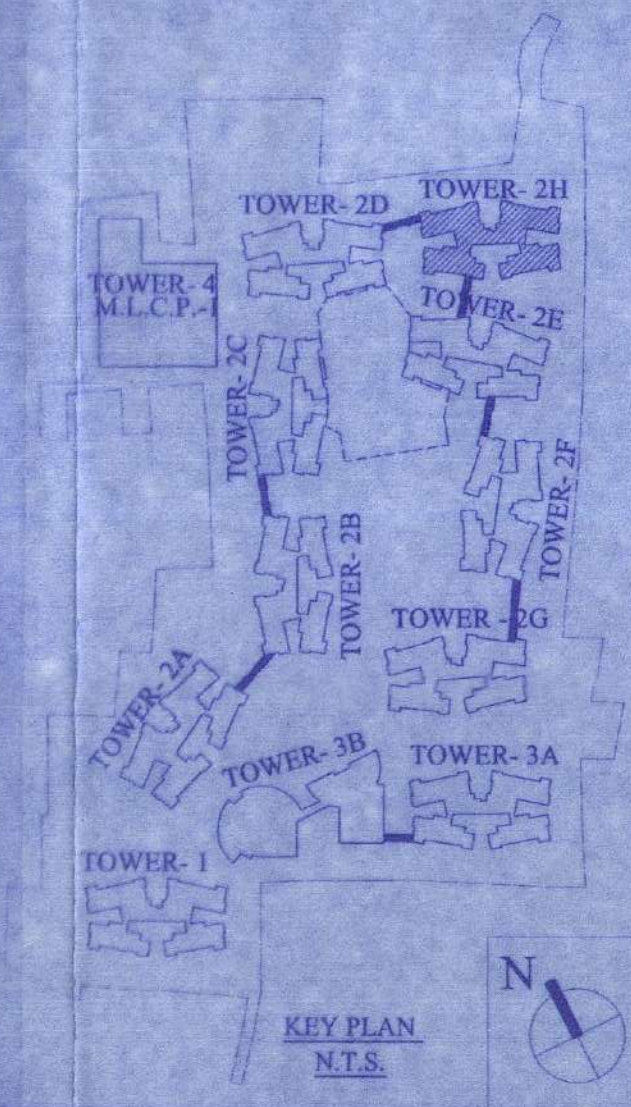

KEY PLAN

NAME OF OWNER	NAME OF THE COMPANY
12.M/s. Artline Projects Private Limited	64.M/s. Kalakriti Enclave Private Limited
13.M/s. Artline Realestate Private Limited	65.M/s. Kalakriti Homes Private Limited
14.M/s. Average Complex Private Limited	66.M/s. Kalakriti Housing Private Limited
15.M/s. Average Housing Private Limited	67.M/s. Kalakriti Properties Private Limited
16.M/s. Average Infracon Private Limited	68.M/s. Kalakriti Realty Private Limited
17.M/s. Average Nirman Private Limited	69.M/s. Kamyabi Consultants Private Limited
18.M/s. Average Projects Private Limited	70.M/s. Lifelong Enclave Private Limited
19.M/s. Basudev Enclave Private Limited	71.M/s. Limelight Hirise Private Limited
20.M/s. Basudev Housing Private Limited	72.M/s. Linkrose Constructions Private Limited
21.M/s. Bluebird Tie Up Private Limited	73.M/s. Linkrose Housing Private Limited
22.M/s. Booster Heights Private Limited	74.M/s. Linkrose Residency Private Limited
23.M/s. Booster Hirise Private Limited	75.M/s. Manobal Dealer Private Limited
24.M/s. Brijbhumi Agents Private Limited	76.M/s. Manobal Vanijya Private Limited
25.M/s. Brijbhumi Tie Up Private Limited	77.M/s. Matrix Sales Private Limited
26.M/s. Citywings Vyapar Private Limited	78.M/s. Maslow Barter Private Limited
27.M/s. Crossway Heights Private Limited	79.M/s. Moonlife Constructions Private Limited
28.M/s. Crossway Nirman Private Limited	80.M/s. Moonlife Nirman Private Limited
29.M/s. Dayanidhi Suppliers Private Limited	81.M/s. Moonlife Residency Private Limited
30.M/s. Delta Vyapar Private Limited	82.M/s. Mridul Advisory Private Limited
31.M/s. Dhanganga Hirise Private Limited	83.M/s. Newwave Merchants Private Limited
32.M/s. Dhanganga Infracon Private Limited	84.M/s. Original Realty Private Limited
33.M/s. Dhanganga Realty Private Limited	85.M/s. Panghat Supply Private Limited
34.M/s. Dhanganga Residency Private Limited	86.M/s. Pawanputra Barter Private Limited
35.M/s. Dreamland Hirise Private Limited	87.M/s. Pawanputra Sales Private Limited
36.M/s. Elegant Nirman Private Limited	88.M/s. Prabakar Barter Private Limited
37.M/s. Gajbadan Vinimay Private Limited	89.M/s. Prajapati Commercial Private Limited
38.M/s. Gajgami Buldocon Private Limited	90.M/s. Prajapati Dealer Private Limited
39.M/s. Gajgami Constructions Private Limited	91.M/s. Prensagar Advisory Private Limited
40.M/s. Gajgami Hirise Private Limited	92.M/s. Prensagar Tie Up Private Limited
41.M/s. Gajgami Realty Private Limited	93.M/s. Prime Rose Marketing Private Limited
42.M/s. Gajmukhi Enclave Private Limited	94.M/s. Radial Housing Private Limited
43.M/s. Gajmukhi Homes Private Limited	95.M/s. Radial Residency Private Limited
44.M/s. Gajmukhi Infracon Private Limited	96.M/s. Rimjhim Commodities Private Limited
45.M/s. Gajmukhi Nirman Private Limited	97.M/s. Rosemary Distributors Private Limited
46.M/s. Gajmukhi Projects Private Limited	98.M/s. Rosemary Tie Up Private Limited
47.M/s. Gajmukhi Realestate Private Limited	99.M/s. Sadabahar Vyapar Private Limited
48.M/s. Ganesh Tracom Private Limited	100.M/s. Sagun Advisory Services Private Limited
49.M/s. Gameshanti Promoters Private Limited	101.M/s. Sanjivani Vanijya Private Limited
50.M/s. Greentop Nirman Private Limited	102.M/s. Sargam Vyapar Private Limited
51.M/s. Guidance Vyapar Private Limited	103.M/s. Sawarg Vanijya Private Limited
52.M/s. Gullmarg Vyapar Private Limited	104.M/s. Shivasthal Dealers Private Limited
53.M/s. Hanurang Tie Up Private Limited	105.M/s. Shivasthal Sales Private Limited
54.M/s. Indvar Tracom Private Limited	106.M/s. Sidha Style Barter Private Limited
55.M/s. Jaijendra Distributors Private Limited	107.M/s. Sishant Suppliers Private Limited
56.M/s. Jaijendra Marketing Private Limited	108.M/s. Silverline Vinimay Private Limited
57.M/s. Jaijendra Merchants Private Limited	109.M/s. Skylink Merchants Private Limited
58.M/s. Jaldham Advisory Private Limited	110.M/s. Spandan Suppliers Private Limited
59.M/s. Jaldham Tie Up Private Limited	111.M/s. Splendor Vyapar Private Limited
60.M/s. Jilmiti Sales Private Limited	112.M/s. Style Merchants Private Limited
61.M/s. Jitendra Vyapar Private Limited	113.M/s. Subhjit Vyapar Private Limited
62.M/s. Jitendra Merchants Private Limited	114.M/s. Sunmart Vyapar Private Limited
63.M/s. Juhl Marketing Private Limited	115.M/s. Sunshine Barter Private Limited
	116.M/s. Superior Complex Private Limited
	117.M/s. Superior Hirise Private Limited
	118.M/s. Superior Hirise Private Limited
	119.M/s. Sursarita Advisory Services Private Limited
	120.M/s. Sursarita Consultants Private Limited
	121.M/s. Swastik Barter Private Limited
	122.M/s. Terapanth Consultancy Services Private Limited
	123.M/s. Timeless Realestate Private Limited
	124.M/s. Topcon Vyapar Private Limited
	125.M/s. Vidhata Advisory Services Private Limited

Authorised Signatory
 Signature of Owner
 NAME: MONAL AGRAWAL
 ENROLLMENT NO. ACHR/NKDA/10/00020

SCHEDULE OF DOORS & WINDOWS			
NO.	SILL	LINTEL	SIZE
D	-	2150	1200 X 2150
D1	-	2150	900 X 2150
D1a	250	2300	900 X 2050
D2	-	2150	750 X 2150
D2a	-	2150	700 X 2150
D3	-	2150	1000 X 2150
DW	-	2400	2985 X 2400
DW1	-	2400	2345 X 2400
SD	-	2150	2100 X 2150
SD1	-	2150	1600 X 2150
F.C.D	-	2150	1125 X 2150
F.C.D1	-	2150	1198 X 2150
W	350	2150	2400 X 1800
W1	350	2150	2100 X 1800
W2	350	2150	1200 X 1800
W3	350	2150	850 X 1800
W4	1100	2150	1200 X 1050
W5	1250	2150	600 X 900
W6	350	2150	1200 X 1800
W7	750	2150	700 X 1400
SW	750	2450	1198 X 1700

CERTIFICATE OF GEO - TECHNICAL ENGINEER
 IT IS CERTIFIED THAT THE COMPREHENSIVE GEOTECHNICAL REPORT ON SOIL INVESTIGATION HAS BEEN PREPARED BY ME FOR DESIGN AND CALCULATION OF THE FOUNDATION BY ANALYZING THE SOIL SAMPLES FOR ESTIMATING THE BEARING CAPACITY OF THE SOIL ON WHICH FOUNDATION OF THE STRUCTURE WILL BE CONSTRUCTED. I SHALL ALSO CHECK THE NATURE OF THE SOIL AFTER EXCAVATION AT SITE SO THAT FOUNDATION IS EXTENDED UP TO THE APPROPRIATE DEPTH THAT HAS BEEN PROPOSED IN THE GEO-TECHNICAL REPORT.

Jishnu Pal
 JISHNU PAL
 B.Tech (Civil), M.E. (Geo-tech)
 REG. NO. G-2 / 1 / 32
 GTER / NKDA / 10 / 0943
 22 / RISON / G-T-1 / 2016-17

SIGNATURE OF GEO - TECHNICAL ENGINEER
 NAME - Jishnu Pal
 ENROLLMENT NO. - GTER-NKDA/10/0943

CERTIFICATE OF STRUCTURAL ENGINEER
 I CERTIFY THAT THE STRUCTURAL DRAWING AND DESIGN OF BOTH THE FOUNDATION AND SUPERSTRUCTURE OF THE BUILDING BUILDINGS HAS BEEN MADE CONSIDERING THE SOIL TEST REPORT, AS PER THE RULES AND REGULATIONS MADE UNDER THE ACT AND ALSO CONSIDERING ALL POSSIBLE LOADS, SEISMIC LOAD AND THE MOMENTS GENERATED BY THE PROPOSED STRUCTURE AS PER THE BUREAU OF INDIAN STANDARD AND NATIONAL BUILDING CODE OF INDIA AND CERTIFIED THAT IT IS SAFE AND STABLE IN ALL RESPECT AND THESE PROVISIONS SHALL BE ADHERED TO DURING THE CONSTRUCTION.

Subir Ranjan Sarkar
 SANJIV J. PAREKH
 M.E. (STRUCT), M.E. (CONSTR. ENGR.),
 B.C.E. - FILE (E-182024)
 STER/NKDA / 10 / 00020

SIGNATURE OF STRUCTURAL ENGINEER
 NAME - Sanjiv Parekh
 ENROLLMENT NO. - STER/NKDA/10/00020

CERTIFICATE OF ARCHITECT
 I CERTIFY THAT ALL THE ARCHITECTURAL DRAWINGS OF THE PROJECT AT R.S.DAG NOS. 470(P), 471(P), 472, 473, 474, 475, 476, 477, 478, 479, 480, 481, 482, 483, 484, 485, 486, 487, 488, 489, 490, 491, 492, 493, 494, 495, 496, 497, 498, 499, 500, 501(P), 502(P), 503, 504(P), 505(P), 506(P), 507(P), 508(P), 509(P), 510(P), 511(P), 512(P), 513(P), 514(P), 515(P), 516(P), 517(P), 518(P), 519(P), 520(P), 521(P), 522(P), 523(P), 524(P), 525(P), 526(P), 527(P), 528(P), 529(P), 530(P), 531, 532, 533 & 501/716(P) OF MOUZA - BHATINDA, J.L. NO.28 HAS BEEN PREPARED BY ME COMPLYING WITH THE NEW TOWN KOLKATA PLANNING AREA (BUILDING) RULES, 2014. I ALSO CERTIFY THAT THE PLANS AND DRAWINGS PREPARED BY ME COMPLYING WITH ALL THE PROVISIONS REGARDING THE FIRE PROTECTION AS PER THE PREVAILING NATIONAL BUILDING CODE OF INDIA. I SHALL BE HELD RESPONSIBLE IF ANY INCORRECT INFORMATION IS FURNISHED BY ME OR ANY VIOLATION OF PROVISIONS OF THESE RULES OR THE PREVAILING NATIONAL BUILDING CODE IS FOUND IN ANY OF THE DRAWINGS AND DOCUMENTS, SIGNED BY ME AND SUBMITTED TO THE SANCTIONING AUTHORITY FOR OBTAINING SANCTION.

Monal Agrawal
 MONAL AGRAWAL
 Regd. Architect
 New Town Kolkata Development Authority
 Enrolment No. ACHR/NKDA/10/00020

SIGNATURE OF ARCHITECT
 NAME - MONAL AGRAWAL
 ENROLLMENT NO. - ACHR/NKDA/10/00020

SIGNATURE OF TOWN PLANNER OR URBAN DESIGNER
 NAME - Subir Ranjan Sarkar
 ENROLLMENT NO. - TPER/NKDA/10/00036

SIGNATURE OF STRUCTURAL REVIEWER
 NAME - Sanjiv Parekh
 ENROLLMENT NO. - STER/NKDA/10/00020

TITLE
 ROOF PLAN AND FRONT ELEVATION TOWER - 2H

PROJECT
 PROPOSED ADDITION OF 1NO. (G+X IX) STORIED RESIDENTIAL BUILDING NAMEDLY TOWER-2H & REVISION OF 1NO. (L+UG-VII) STORIED MLCF BUILDING NAMEDLY TOWER - 4 WITH PREVIOUS SANCTIONED OF 1NO. (G+IX) STORIED RESIDENTIAL BUILDING NAMEDLY TOWER - 1, 2A, 2G & 3A 2B, 2C, 2D, 2E & 2F APPROVED BY EXECUTIVE OFFICER RAJAHAT PANCHAYAT SAMITI VIDE MEMO NO. 926/RPS DATED 28/08/2018.

IN WHICH OCCUPANCY CERTIFICATE HAS BEEN OBTAINED FOR ANOS. TOWER NAMEDLY TOWER - 1, 2A, 2G & 3A VIDE MEMO NO. 2696/RPS DATED 01.08.2019 FROM RAJAHAT PANCHAYAT SAMITI, IN RESIDENTIAL COMPLEX AT MOUZA BHATINDA, J.L. NO. 28, R.S./L.R. DAG NOS. 407(PART), 471(PART), 473, 474, 475, 476, 477, 478, 479, 480, 481, 482, 483, 484, 485, 486, 487, 488, 489, 490, 491, 492, 493, 494, 495, 496, 497, 498, 499, 500, 501(PART), 502(PART), 503, 504(PART), 505(PART), 506(PART), 507(PART), 508(PART), 509(PART), 510(PART), 511(PART), 512(PART), 513(PART), 514(PART), 515(PART), 516(PART), 517(PART), 518(PART), 519(PART), P.S. - RAJAHAT, WITHIN THE JURISDICTION OF RAJAHAT BISHNUPUR NO. 1 GRAM PANCHAYAT, DIST. - NORTH 24 PARGANAS.

ARCHITECTS
 AGRAWAL & AGRAWAL
 BARODA KOLKATA
 SCALE DATE SHEET NO. DEALT CHECKED
 1:100 05.03.2021 7 OF 11 GARGI SHILA

ARCHITECT:
Monal Agarwal
CIVIL/STRUCTURAL ENGINEER:
Sanjiv Parakh
BEO-TECHNICAL ENGINEER:
Jishnu Pal
TOWN PLANNER/URBAN DESIGNER:
Subir Royan Saha
STRUCTURAL REVIEWER:
Sanjib Guha

Enrollment No: ACHR/NKDA/10/00020
Enrollment No: STER/NKDA/10/00020
Enrollment No: GTER/NKDA/10/00043
Enrollment No: TPER/NKDA/10/00026
Enrollment No: STRV/NKDA/10/00003

STRUCTURAL DRAWINGS, STRUCTURAL DESIGN CALCULATIONS & SOIL TEST REPORT ARE NOT CHECKED AND KEPT FOR RECORDS ONLY.

Note: This NOC has been issued on the basis of documents submitted by the applicant. It is not to be taken as a guarantee of the correctness of the data or the accuracy of the drawings. The applicant is responsible for the correctness of the data and the accuracy of the drawings. In case of any act of suppression of facts in connection with the above project including the concealed load, spans, drawings, design etc., then this NOC shall stand cancelled.

8/11
BL-2H
Roof Plan & Front Elevation

SANCTIONED & APPROVED
Ras
Executive Officer
Rajarhat Panchayat Samity
Rajarhat, North 24 Parganas

Approval Order No. 287/KPS
Date: 8/2/22
Valid up to: 7/3/27

NEW TOWN KOLKATA DEVELOPMENT AUTHORITY
No Objection Certificate for
Sanction of Building Plan for Construction Purpose
Memo No. AS/NKDA/BFS-04(3)/2020
Date: 24/01/22

Building Particulars Proposed addition of one (6+1x19) storied residential building (Tower-24) and revision of HLEP block at mouza- Bhatenda, T.L No. 28, North 2A Pgs.

Note: All the recommendations from Pollution Control Board is to be followed thoroughly at the time of construction.

Sayant Majumder
Assistant Architect
New Town Kolkata Development Authority

Tapan Kumar Dwari
Chief Architect
New Town Kolkata Development Authority